

APPLICATIONS:

Liquid level controller for oil and gas separators, water knock-outs, gas scrubbers and accumulators.

Operates any pressure opening diaphragm motor valve requiring not more than 30 psig diaphragm pressure. See sections E1, E2, E3 and E4 for diaphragm operated motor valves.

FEATURES:

- Intermittent vent pilot
- Simple installation
- Easy to use
- Polyethylene displacement float
- .65 Specific Gravity or higher
- No adjustment required

OPERATION:

The ULC Pilot consists of a DISPLACEMENT FLOAT for monitoring the liquid level, a trunnion and shaft to transmit float movement, and a pilot case which contains a PILOT BODY, SPRING ARM and ACTUATOR ASSEMBLY.

As the liquid level rises, the displaced volume of liquid plus the force of the COUNTERBALANCE SPRING lifts the FLOAT, rotating the trunnion and SPRING ARM in a clockwise direction. This draws the ACTUATOR ASSEMBLY downward, closing the vent (Yellow to Atmosphere) and opening the inlet (Violet to Yellow). Yellow pressure opens the motor valve.

As the liquid level lowers, the weight of the FLOAT forces the trunnion and SPRING ARM in a counter-clockwise direction. This pushes the ACTUATOR upward, closing the inlet (Violet to Yellow) and opening the vent (Yellow to Atmosphere). Vented yellow pressure allows the motor valve to close.

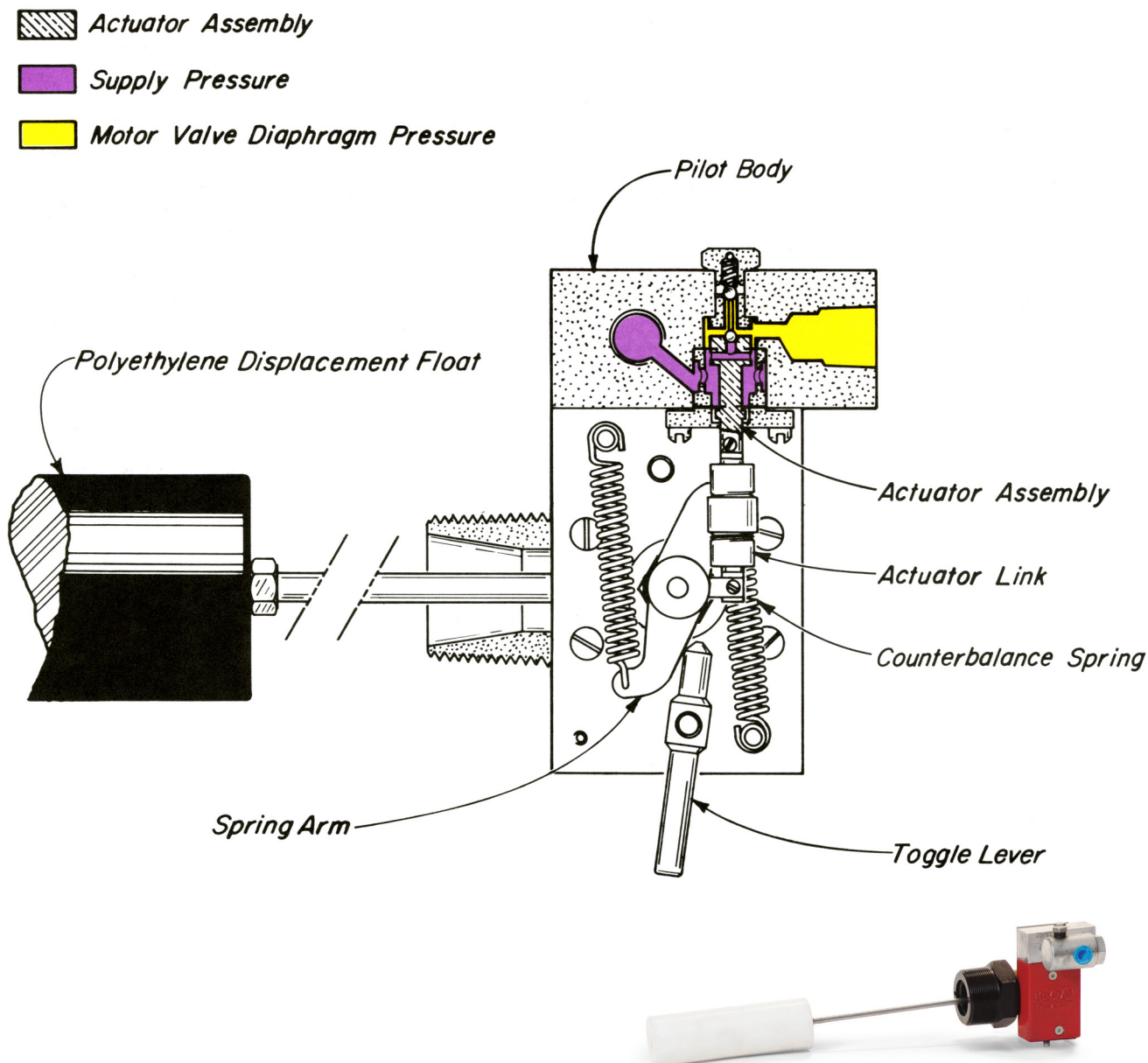

Kimray is an ISO 9001- certified manufacturer.

FLOAT OPERATED LEVEL CONTROLLER

KIMRAY INC.®

UNIVERSAL LEVEL CONTROLLER

BRASS, STEEL & STAINLESS STEEL - 0-1500 psig OPER. PRES.

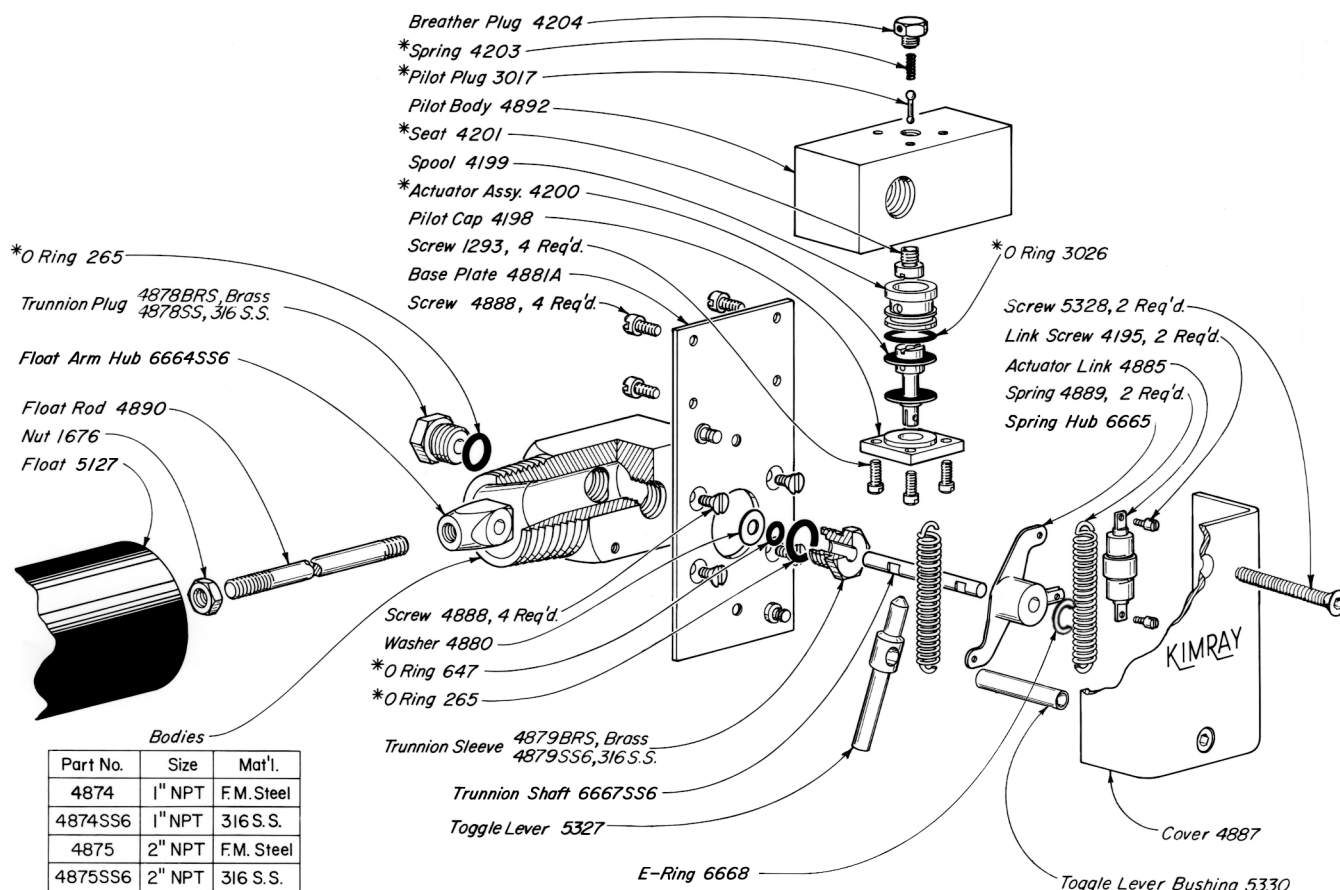

Parts for pilots available with pipe vent not shown are
Breather plug 147, Screw 1293 (4) required, Pilot Body
4892PV, Breather plug 4893.

PILOTS ACCESSORIES AVAILABLE:

PART NO.	DESCRIPTION
6001	4" Hammer Union Adapter for 1" NPT Pilot

CONTROLLERS AVAILABLE:

PART NO.	BODY CONNECTION	MODEL NO.	SUPPLY PRES.	MAX W.P.	REP. KIT
CMB	1" NPT	ULC STEEL	0-30	1500	RSL
CMC	1" NPT	ULC SS6	0-30	1500	RSL
CMD	2" NPT	ULC STEEL	0-30	1500	RSL
CME	2" NPT	ULC SS6	0-30	1500	RSL
CMG	1" NPT	ULC STL W/PIPE VENT	0-30	1500	RSL
CMH	1" NPT	ULC SS6 W/PIPE VENT	0-30	1500	RSL
CMI	2" NPT	ULC STL W/PIPE VENT	0-30	1500	RSL
CMJ	2" NPT	ULC SS6 W/PIPE VENT	0-30	1500	RSL

NOTES:

*These parts are recommended spare parts and are stocked as repair kits.

For standard & optional Seals, Metals & Material specifications see Technical Data on pages C1:1 - C1:V