

#### APPLICATIONS:

The 30 HPG Pressure Switch sends a pneumatic signal when the monitored pressure rises above the desired pressure. The signal vents when the monitored pressure drops below the desired set pressure. The output signal is an on/off signal and is not intended for use as a proportional signal for throttling a motor valve.

The pneumatic source is isolated from the monitored pressure by a vent chamber which allows the monitored pressure to vent away if it reaches a high enough pressure to cause diaphragm failure.

#### FEATURES:

- Single adjustment
- Filtered gas supply
- Accurate control
- Remote installation
- Direct, on/off action

#### CLASSIFICATIONS:

Non-Bleed / Intermittent Vent

#### SUPPLY PRESSURE:

Equal to or not less than 60% of maximum upstream pressure when used to operate low pressure control valves.

20-30 psig when used to operate high pressure control valves.

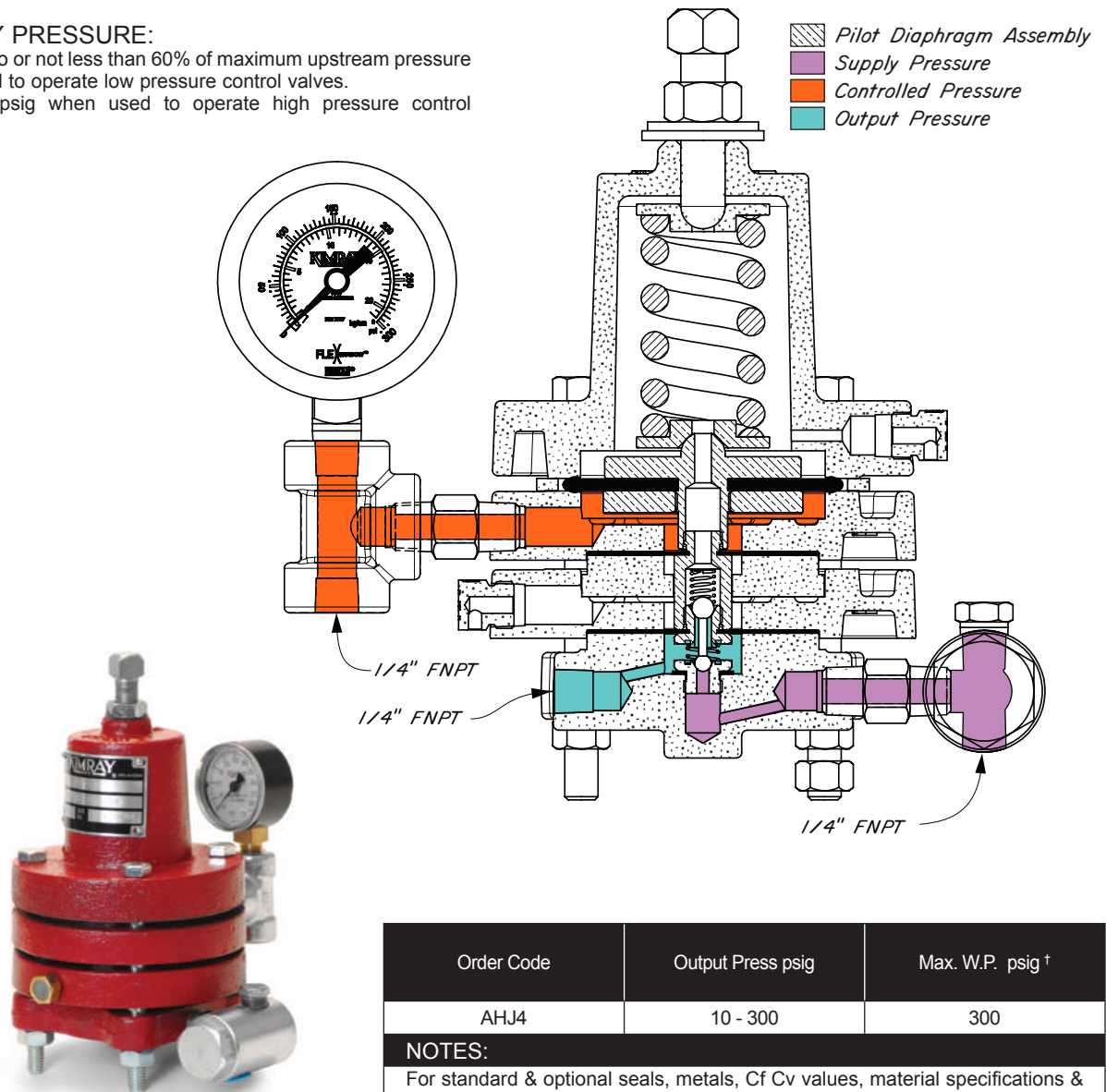

*DIRECT ACTING PRESSURE SWITCH  
DRAWING & PARTS LIST*

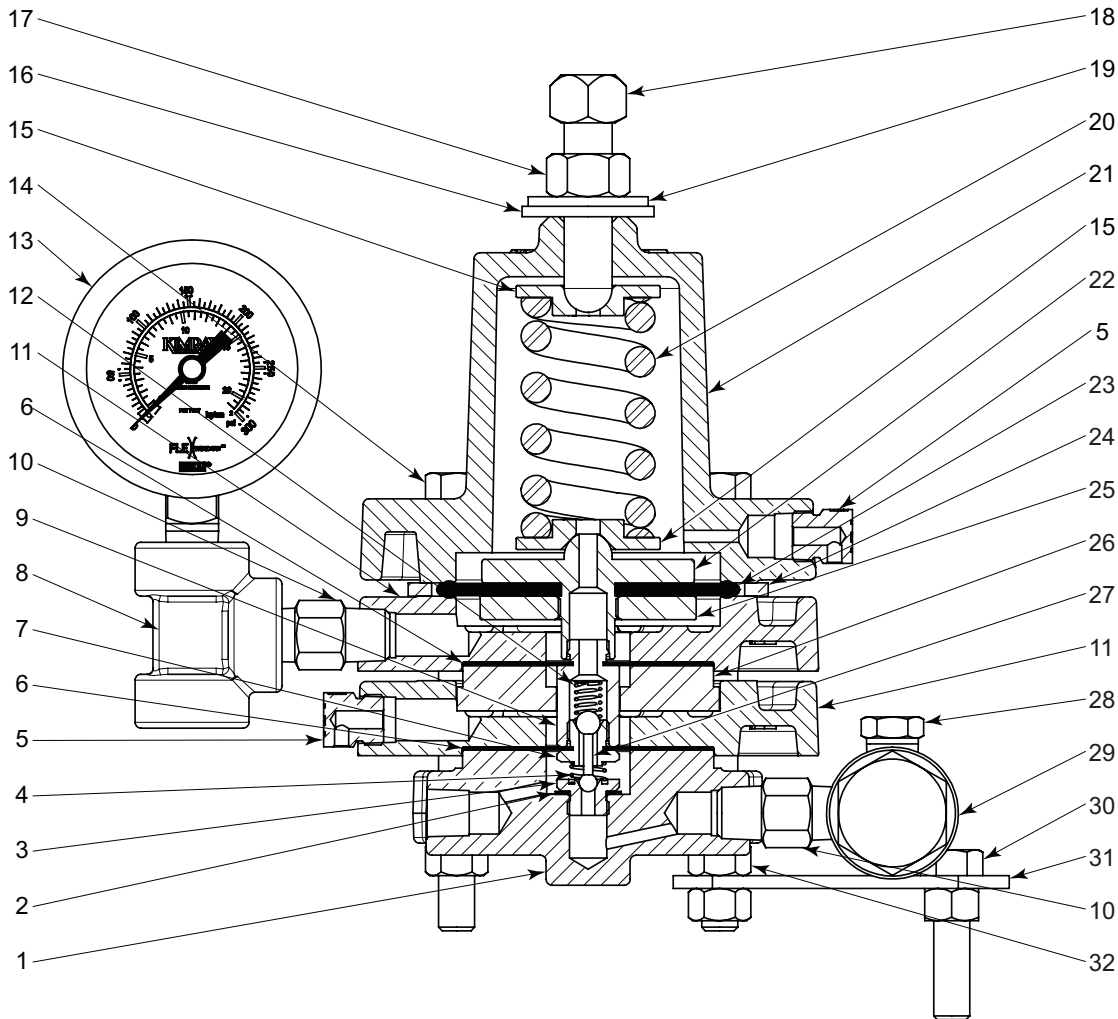

ITEM	QTY.	DESCRIPTION	PART NO		ITEM	QTY.	DESCRIPTION	PART NO	
			STANDARD	CORROSIVE				STANDARD	CORROSIVE
1	1	Base Plate	2607		17	1	Nut	2377	
2	1	Gasket *	118		18	1	Adjusting Screw	5163	5163SS6
3	1	Seat *	113	113SS6	19	1	Washer *	4491	
4	1	Booster Spring *	566	566HAC	20	1	Spring	2611	
5	2	Breather Plug	147	147SS6	21	1	Bonnet	2610	
6	2	Diaphragm *	110		22	1	Diaphragm Plate	116	116SS6
7	1	Seat *	565	565SS6	23	1	Diaphragm *	5259P	
8	1	Tee	2000	2000SS6	24	1	Ring *	7437	
9	1	Seat Extension	4297		25	1	Nut	107	107SS6
10	2	Nipple	648	648SS6	26	1	Spacer Ring	2021	
11	2	Housing	1701		27	1	Pilot Plug *	112	
12	1	Spring *	585		28	1	Plug	699	699SS6
13	1	Gauge	7707		29	1	Filter	YAS	YASSS6
14	4	Screw	4298		30	2	Screw	430	
15	2	Spring Plate	2612	2612SS6	31	1	Mounting Bracket	4428	
16	1	Packing Seal *	4488		32	8	Nut	241	
* These parts are recommended spare parts and are stocked as repair kits.							Repair Kit	RSR	RSRV

All Pictures shown are for illustration purpose only. Actual product may vary due to product enhancement.

CODE BUILDER  
P SERIES (PILOTS)

Series:

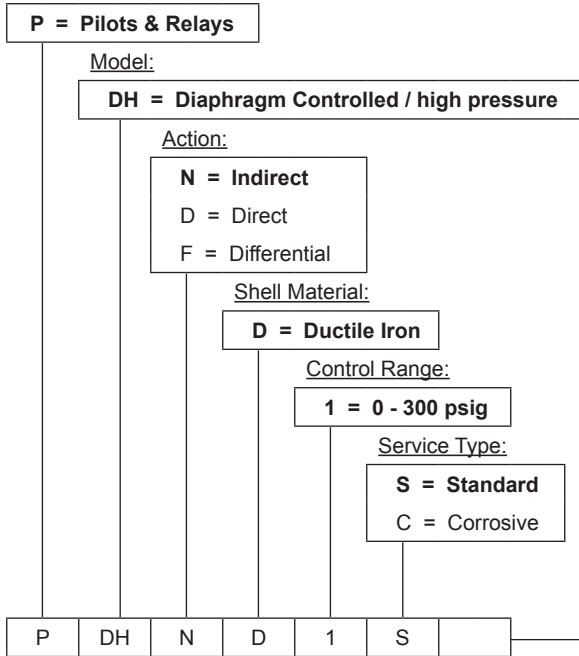

Not all selections available on all products listed.  
See product pages 01:10.1 - 01:10.6 for available options

Options: Additional cost and lead times will apply  
If multiple options required input in sequential order  
Leave blank if no options required

- 1 = NACE Certification (Corrosive Option Only)
- 2 = Hydrostatic Test Certification
- 3 = MTR (Shell Components)
- A = AFLAS Elastomer
- H = HSN Elastomer
- V = FKM Elastomer
- X = Export (Hydrostatic test, MTR & 3.1)

Series:

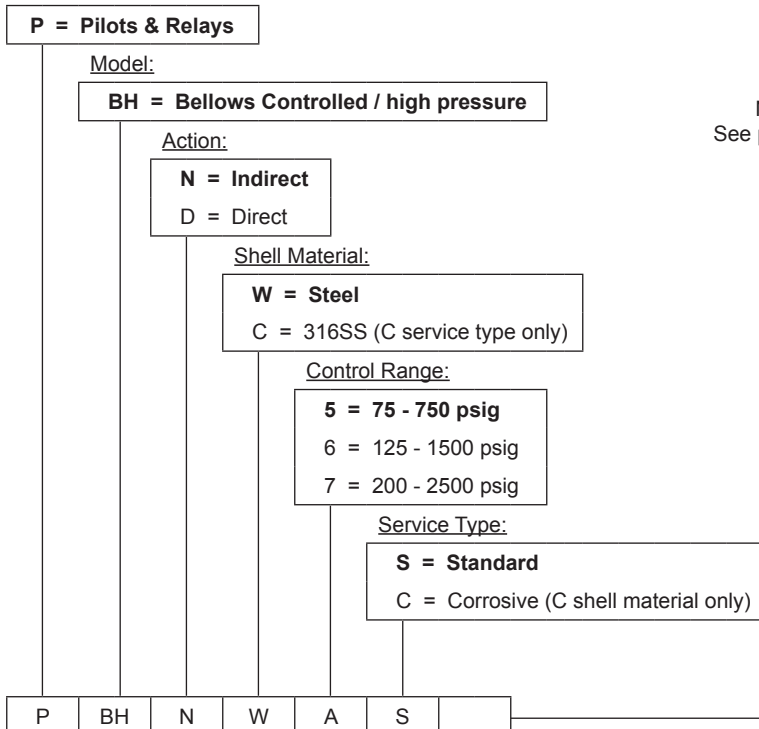

Not all selections available on all products listed.  
See product pages 01:20.1 - 01:20.3 for available options

Options: Additional cost and lead times will apply  
If multiple options required input in sequential order  
Leave blank if no options required

- 1 = NACE Certification (Corrosive Option Only)
- 2 = Hydrostatic Test Certification
- 3 = MTR (Shell Components)
- A = AFLAS Elastomer
- H = HSN Elastomer
- V = FKM Elastomer
- X = Export (Hydrostatic test, MTR & 3.1)