

DIAPHRAGM CONTROLLED LOW PRESSURE / DIRECT ACTING MODEL DL

APPLICATION:

Pilot may be installed remotely from the control valve.
The Pilot is used in the control of low pressure where the desired controlled pressure ranges from a few ounces to 20 psig on:

- Vessels
- Vent lines
- Distribution systems
- Inlet and recirculation on compressors, pressure

Used to produce a proportional pneumatic output signal when the monitored pressure rises above the set pressure. The pneumatic signal source is isolated from the monitored pressure.

FEATURES:

- Single adjustment
- Filtered gas supply
- High accuracy
- Remote installation

CLASSIFICATIONS:

- Non-Bleed / Intermittent Vent

SUPPLY PRESSURE:

Equal to or not less than 60% of maximum upstream pressure when used to operate low pressure control valves.
20-30 psig when used to operate high pressure control valves.

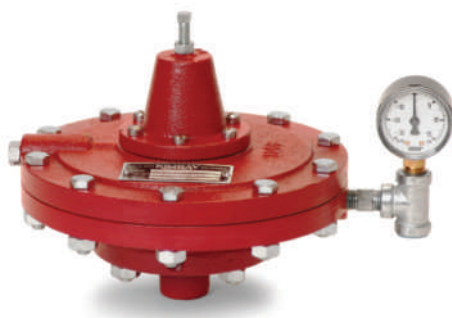
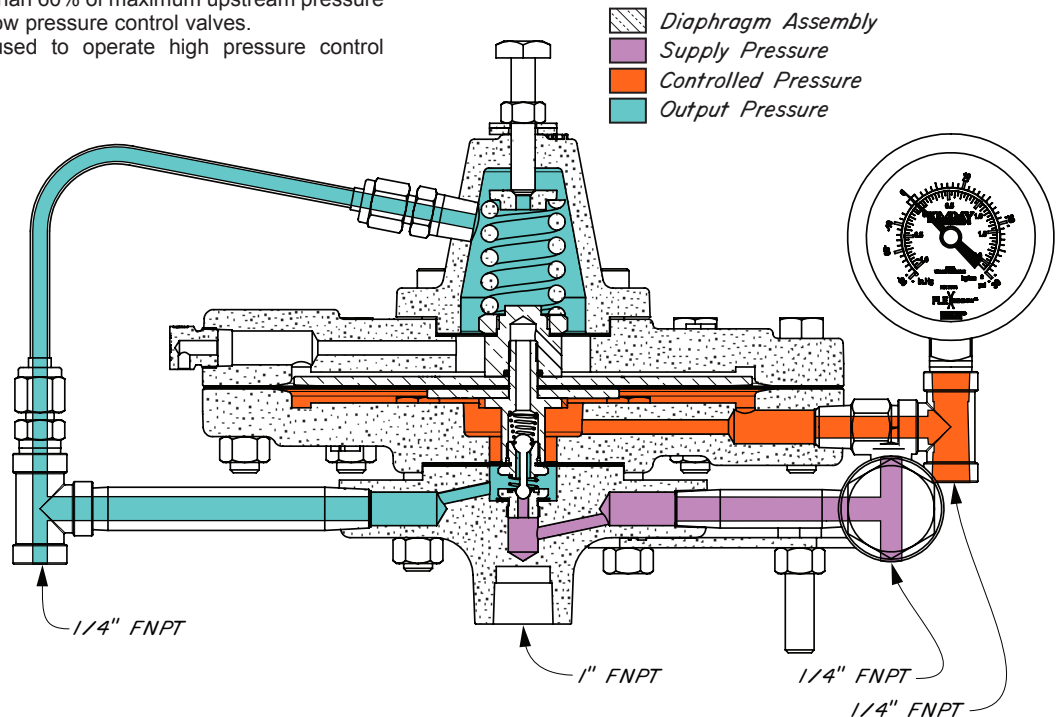

Standard Configuration Code †	Order Code	Operating Pressure	Max. W.P. psig ††
PDLDD2S	YIB2.5	.5 oz - 2.5 psig	175
PDLDD3S	YIB5	1 oz - 5 psig	
PDLDD4S	YIB20	1 psig - 20 psig	

NOTES:

For standard & optional seals, metals, Cf Cv values, material specifications & dimensions see technical data on pages 09:I - 09:IV

† For Corrosive service remove last "S" & replace with "C"

† For code builder see page 09:00.3

†† Max W.P. values based on -20°F to 100°F.

DIAPHRAGM CONTROLLED LOW PRESSURE / DIRECT ACTING
MODEL DL DRAWING & PARTS LIST

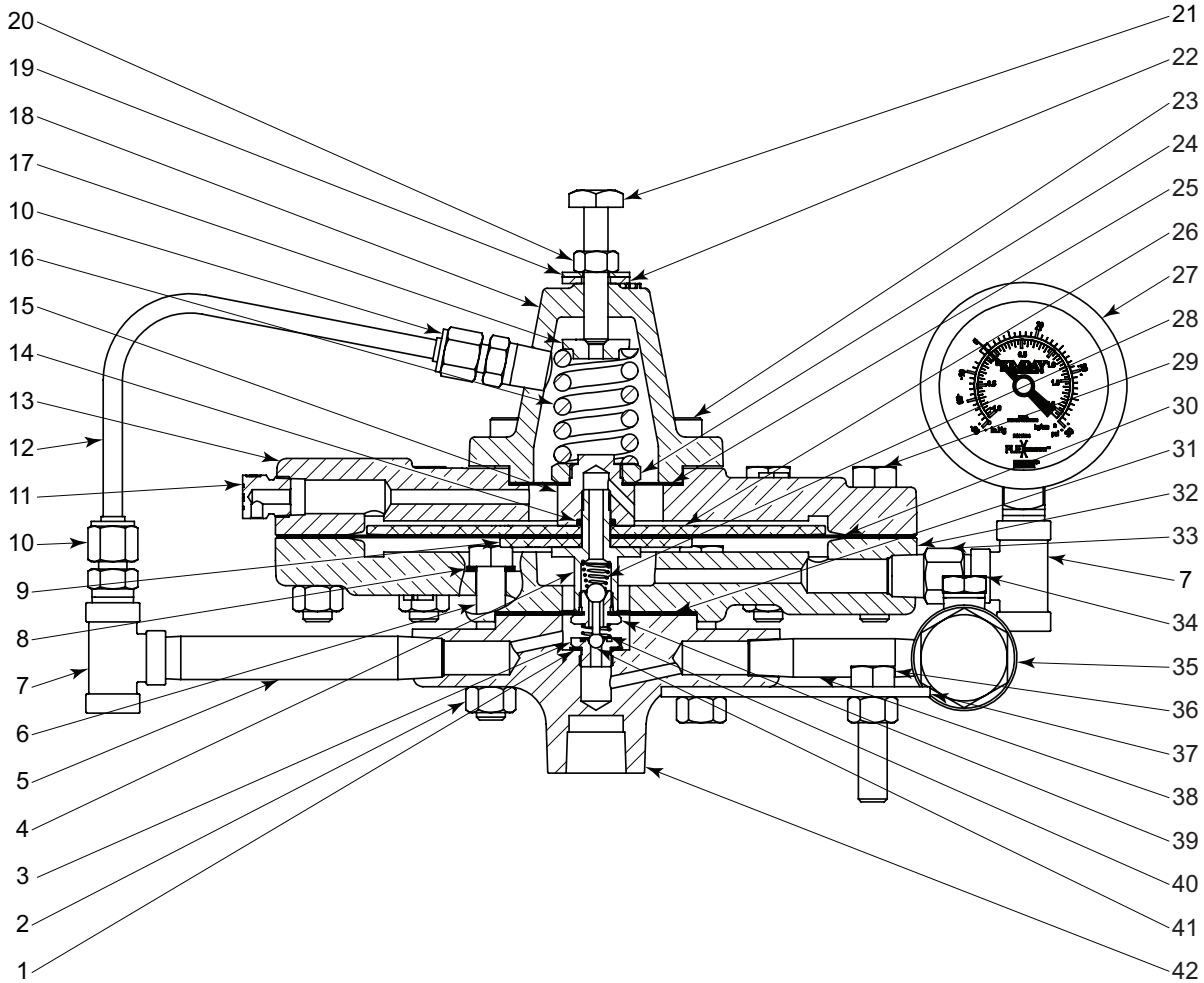

ITEM	QTY.	DESCRIPTION	PART NO		ITEM	QTY.	DESCRIPTION	PART NO	
			STANDARD	CORROSIVE				STANDARD	CORROSIVE
1	1	Gasket *		118	20	1	Nut		922
2	16	Nut		241	21	1	Adjusting Screw		5100
3	1	Seat *	113	113SS6	22	1	Packing Seal *		4490
4	1	Stem	2913	2913SS6	23	6	Screw		7531
5	1	Nipple	75	75SS6	24	1	Diaphragm Nut		5026
6	4	Screw		191	25	1	Diaphragm *		5027
7	2	Tee	219	219SS6	26	1	Upper Diaphragm Plate	1208	1208SS6
8	4	Gasket *		242	27	1	Gauge		7704
9	1	Lower Diaphragm plate	1340	1340SS6	28	1	Spring *	108	108HAC
10	2	Connector		874	29	10	Screw		236
11	1	Vent Plug	147	147SS6	30	1	Diaphragm *		1212
12	1	Tubing		214SS6	31	1	Diaphragm *		110
13	1	Upper Housing		1206	32	1	Lower Housing		1356
14	1	O-Ring *		265	33	1	Nipple	648	648SS6
15	1	Diaphragm Stem	5091	5091S6	34	1	Plug	699	699SS6
16	1	Spring	20 lbs. (standard)	4379	35	1	Filter	YAS	YASS6
			5 lbs. (optional)	3061	36	2	Bolt		430
			2.5 lbs. (optional)	1527	37	1	Mount Bracket		4428
17	1	Spring Plate	20 lbs. (standard)	7148S6	38	1	Nipple		2600
			5 lbs. (optional)	636SS6	39	1	Pilot Seat *	565	565SS6
			2.5 lbs. (optional)		40	1	Spring *	566	566HAC
18	1	Bonnet		5090	41	1	Pilot Plug *		112
19	1	Washer		4492	42	1	Base Plate		962S
* These parts are recommended spare parts and are stocked as repair kits.							Repair Kit	RWN	RWNV

All Pictures shown are for illustration purpose only. Actual product may vary due to product enhancement.

Series:

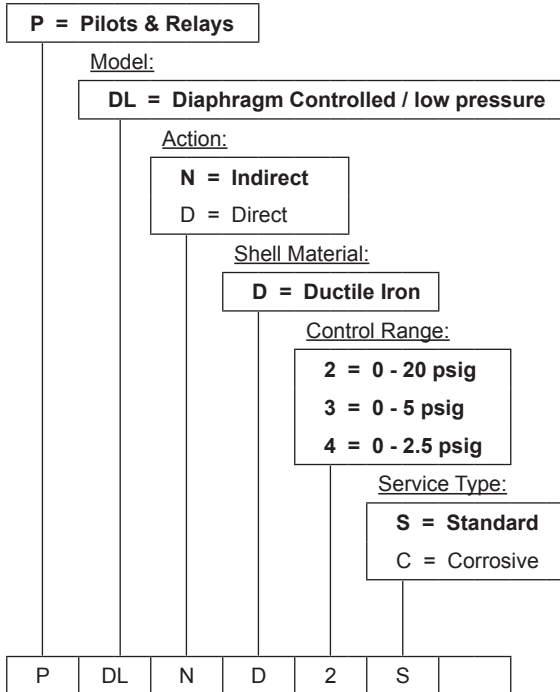

Options: Additional cost and lead times will apply
If multiple options required input in sequential order
Leave blank if no options required

- 1 = NACE Certification (Corrosive Option Only)
- 2 = Hydrostatic Test Certification
- 3 = MTR (Shell Components)
- A = AFLAS Elastomer
- H = HSN Elastomer
- V = FKM Elastomer
- X = Export (Hydrostatic test, MTR & 3.1)

Not all selections available on all products listed.
See product pages 01:30.1 - 01:30.4 for available options