

DIAPHRAGM CONTROLLED LOW PRESSURE / INDIRECT ACTING MODEL DL

APPLICATION:

Pilot may be installed remotely from the control valve.
The Pilot is used in the control of low pressure where the desired controlled pressure ranges from a few ounces to 20 psig on:

- Vessels
- Vent lines
- Distribution systems
- Inlet and recirculation on compressors, pressure

It may be used to produce a pneumatic output signal when the monitored pressure falls below the set pressure. The pneumatic signal source is isolated from the monitored pressure.

FEATURES:

- Single adjustment
- Filtered gas supply
- High accuracy
- Remote installation

CLASSIFICATIONS:

- Non-Bleed / Intermittent Vent

SUPPLY PRESSURE:

Equal to or not less than 60% of maximum upstream pressure when used to operate low pressure control valves.
20-30 psig when used to operate high pressure control valves.

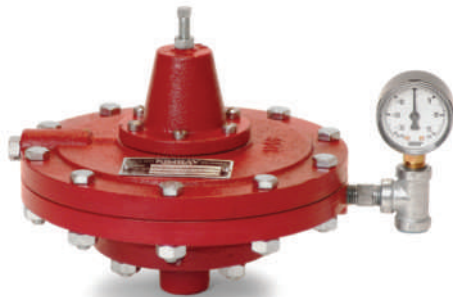
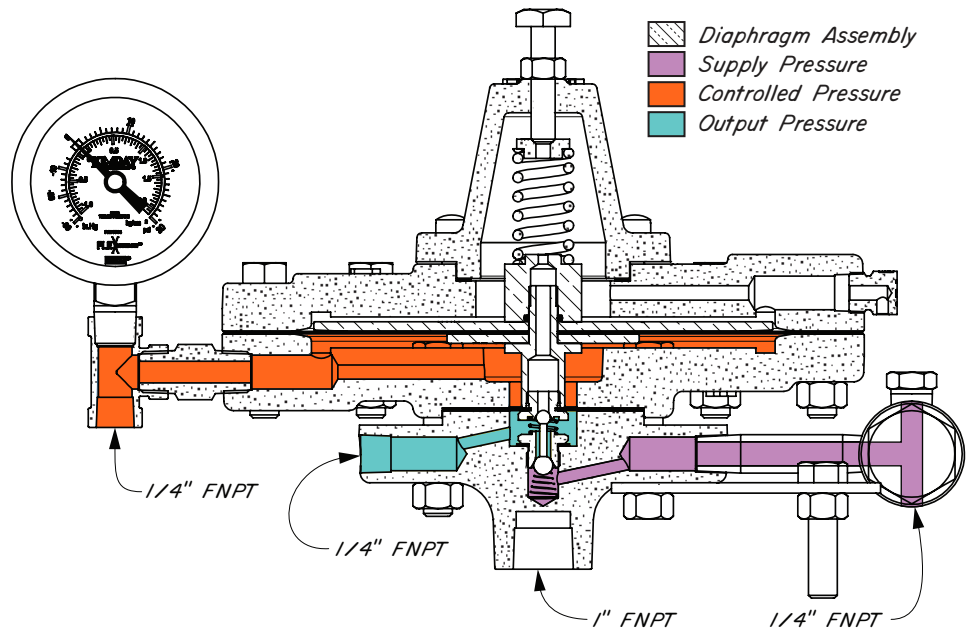

Standard Configuration Code †	Order Code	Operating Pressure	Max. W.P. psig ††
PDLND2S	AHK2.5	.5 oz - 2.5 psig	175
PDLND3S	AHK5	1 oz - 5 psig	
PDLND4S	AHK20	1 psig - 20 psig	

NOTES:

For standard & optional seals, metals, Cf Cv values, material specifications & dimensions see technical data on pages 09:I - 09:IV

† For Corrosive service remove last "S" & replace with "C"

† For code builder see page 09:00.3

†† Max W.P. values based on -20°F to 100°F.

DIAPHRAGM CONTROLLED LOW PRESSURE / INDIRECT ACTING
MODEL DL DRAWING & PARTS LIST

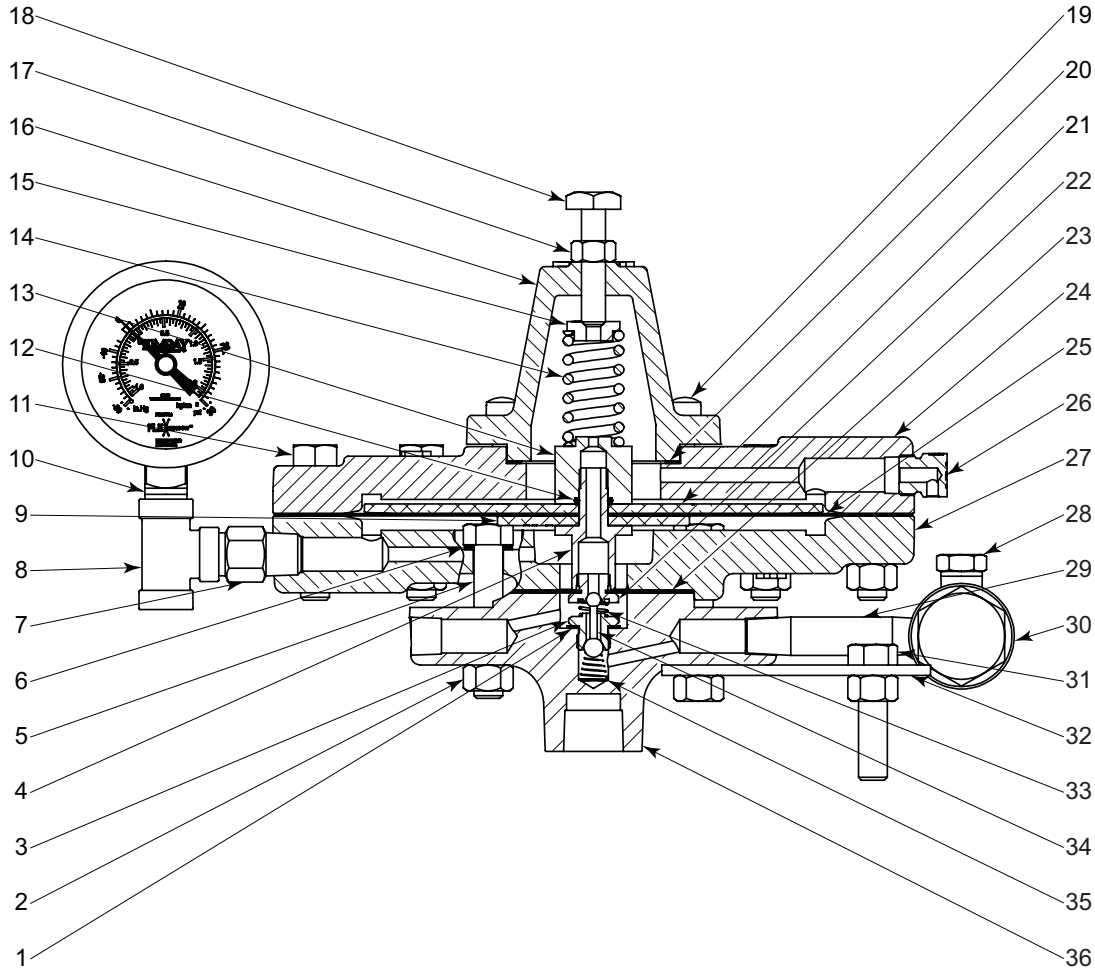

ITEM	QTY.	DESCRIPTION	PART NO		ITEM	QTY.	DESCRIPTION	PART NO	
			STANDARD	CORROSIVE				STANDARD	CORROSIVE
1	1	Gasket *		118	17	1	Nut		922
2	16	Nut		241	18	1	Adjusting Screw		897
3	1	Seat *	565	565SS6	19	6	Screw		7531
4	1	Stem	2913	2913SS6	20	1	Gasket *		1216
5	4	Screw		191	21	1	Upper Diaphragm Plate	1208	1208SS6
6	4	Gasket *		242	22	1	Pilot Seat *	113	113SS6
7	1	Nipple	648	648SS6	23	1	Diaphragm *		110
8	1	Tee	219	219SS6	24	1	Upper Housing		1206
9	1	Lower Diaphragm plate	1340	1340SS6	25	1	Diaphragm *		1212
10	1	Gauge		7704	26	1	Vent Plug		147
11	10	Screw		236	27	1	Lower Housing		1356
12	1	O-Ring *		265	28	1	Plug	699	699SS6
13	1	Diaphragm Nut		2912	29	1	Nipple	75	75SS6
14	1	Spring	20 lbs. (standard)	4379	30	1	Filter	YAS	YASSS6
			5 lbs. (optional)	3061	31	2	Bolt		430
			2.5 lbs. (optional)	1527	32	1	Mount Bracket		4428
15	1	Spring Plate	20 lbs. (standard)	7148S6	33	1	Spring *	566	566HAC
			5 lbs. (optional)	636SS6	34	1	Pilot Plug *		112
			2.5 lbs. (optional)		35	1	Spring *	1360	1360SS6
16	1	Bonnet		1336	36	1	Base Plate		962S
* These parts are recommended spare parts and are stocked as repair kits.							Repair Kit	RWO	RWOV

All Pictures shown are for illustration purpose only. Actual product may vary due to product enhancement.

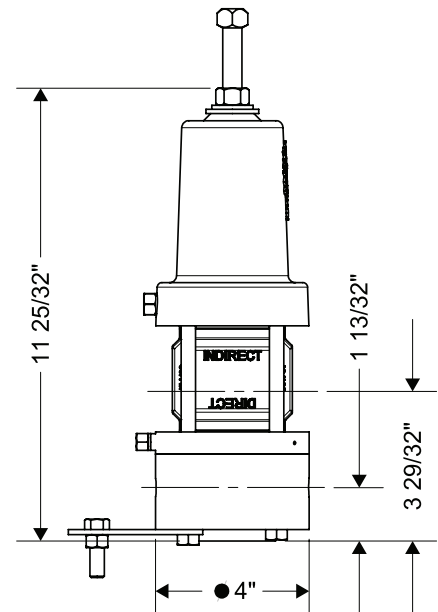
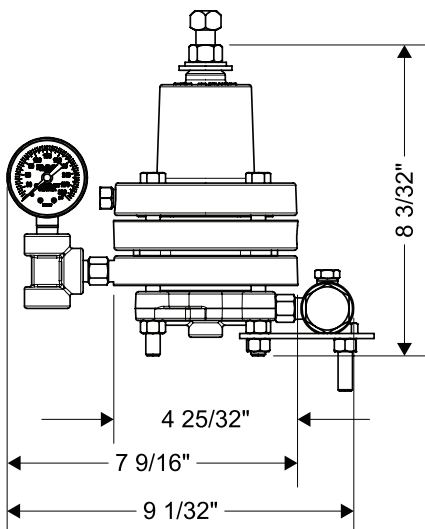
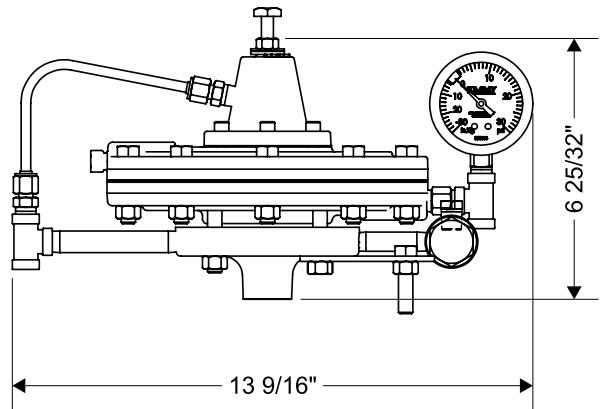
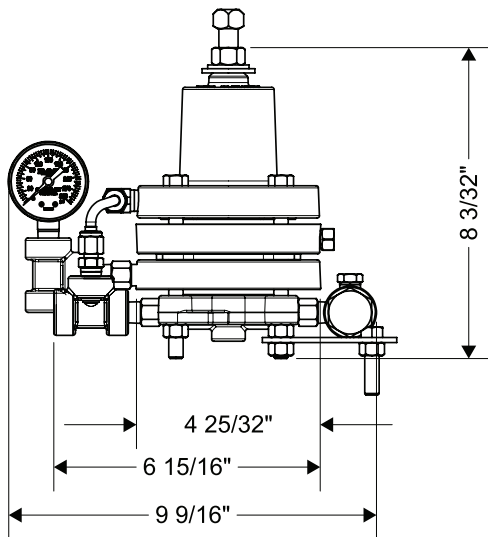
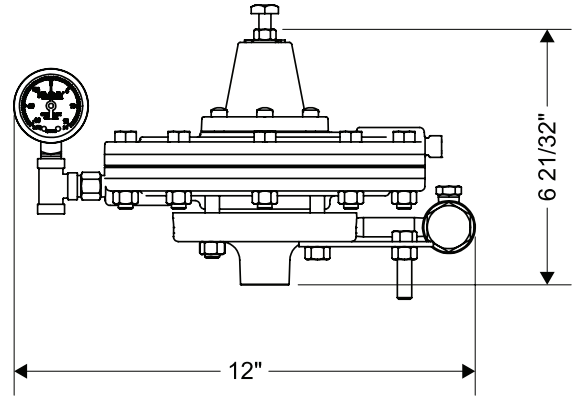
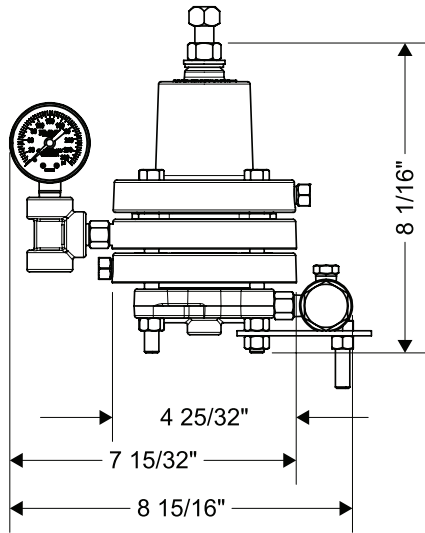

All Pictures shown are for illustration purpose only. Actual product may vary due to product enhancement.

Series:

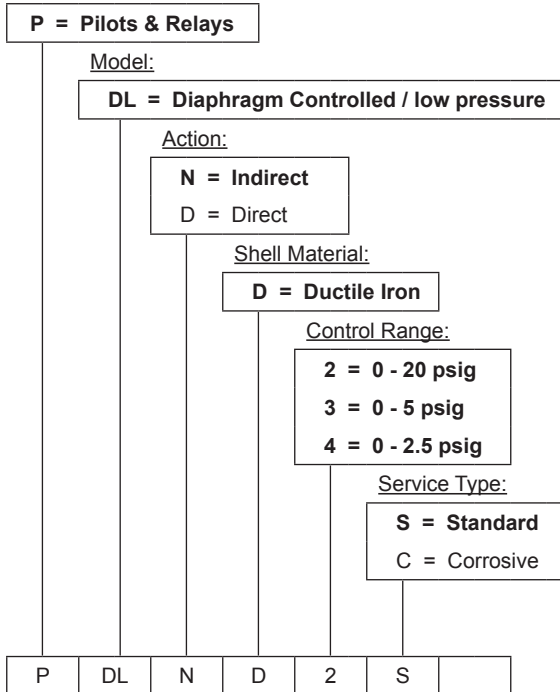

Options: Additional cost and lead times will apply
If multiple options required input in sequential order
Leave blank if no options required

- 1 = NACE Certification (Corrosive Option Only)
- 2 = Hydrostatic Test Certification
- 3 = MTR (Shell Components)
- A = AFLAS Elastomer
- H = HSN Elastomer
- V = FKM Elastomer
- X = Export (Hydrostatic test, MTR & 3.1)

Not all selections available on all products listed.
See product pages 01:30.1 - 01:30.4 for available options