

#### APPLICATION:

The "PDC" Series Pressure Differential Controller connects across the orifice plate of a meter run to maintain a constant stable pressure differential across the meter run. This relates to a constant flow rate when the upstream pressure is constant. This pilot adjusts the flow rate to maintain the pressure differential by positioning a pressure opening motor valve that has characterized equal percentage valve trim for precise flow control.

Precise gas flow rate for gas lift.

Pressure differential control across orifice plates for better charts and measurement of gas flow.

Stabilizes gas flow for better well production.

Pressure differential limiting for reducing "off chart" conditions.







Any applications where a constant pressure differential and flow rate is desired.

#### FEATURES:

- Throttle operation
- 1 to 260 inches of water differential pressure
- Heavier springs available, if specified
- May be used with any type of diaphragm motor valve

#### CLASSIFICATIONS:

Non-Bleed / Intermittent Vent

-  Main Diaphragm Assembly
-  3PTC Pilot Diaphragm Assembly
-  Upstream Pressure
-  Downstream Pressure
-  Supply Pressure
-  Diaphragm Pressure

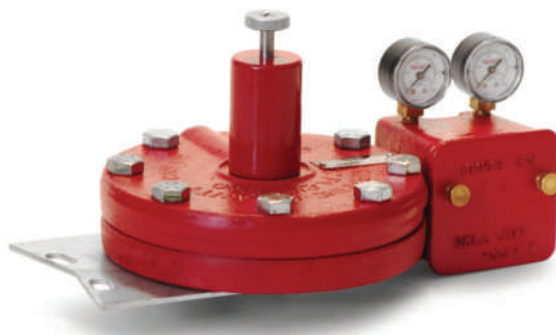
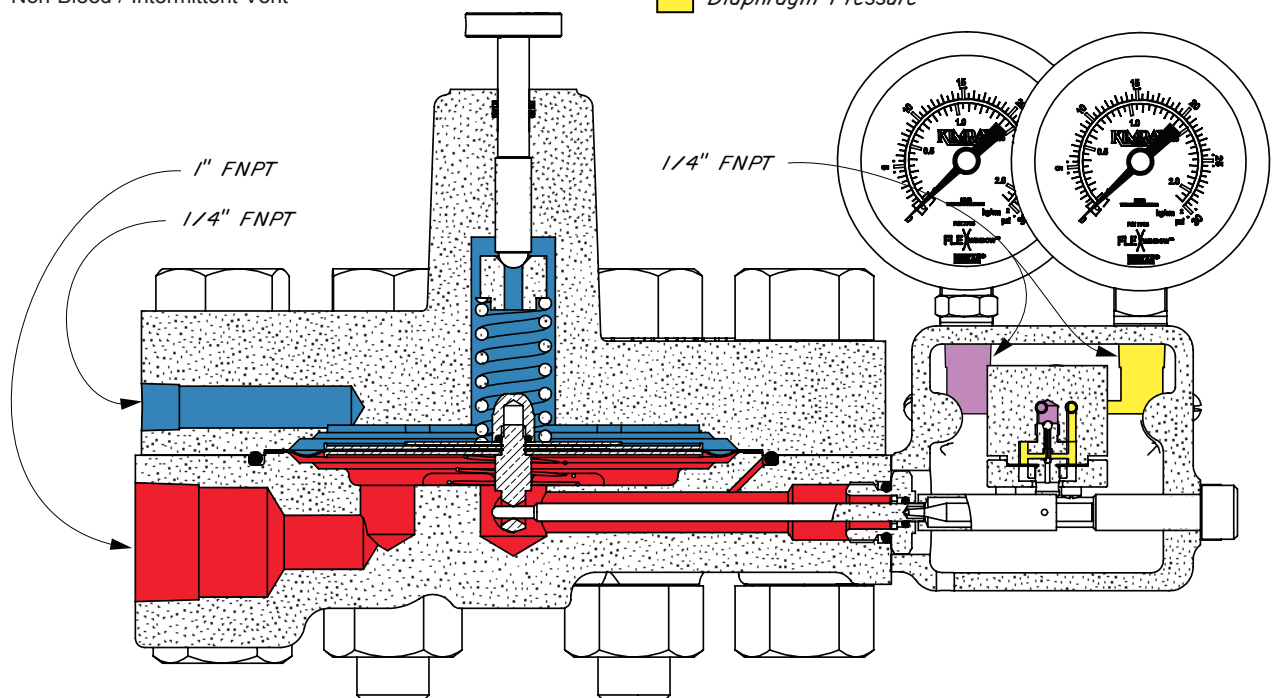

Order Code	Connection size	Supply Press psig	Output Press psig	Max. W.P. psig †
FAA1	1/4"	5 - 30	Variable, 2 - 30	1000
FAA2	1"	5 - 30	Variable, 2 - 30	1000
FAB1	1/4"	5 - 30	Variable, 2 - 30	2000
FAB2	1"	5 - 30	Variable, 2 - 30	2000

#### NOTES:

For standard & optional seals, metals, Cf Cv values, material specifications & dimensions see technical data on pages 09:I - 09:IV

† Max W.P. values based on -20°F to 100°F.

# PILOTS & RELAYS



## PRESSURE DIFFERENTIAL CONTROLLER

### DRAWING & PARTS LIST

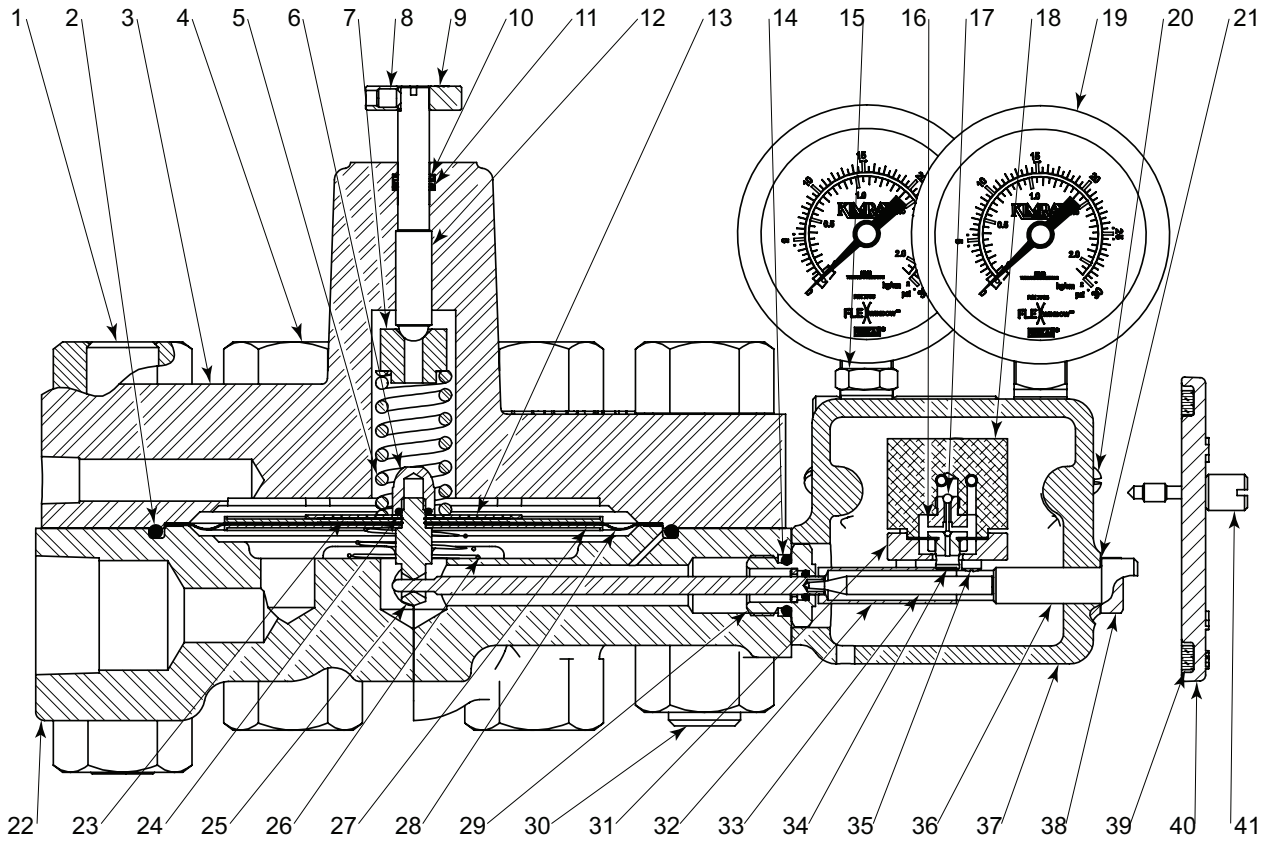

ITEM	QTY.	DESCRIPTION	PART NO	ITEM	QTY.	DESCRIPTION	PART NO	
1	2	Stud 3/4-10 x 4.5	1000 psig 834 2000 psig 83A	24	1	O-Ring	* 638	
2	1	O-Ring	* 87	25	1	Diaphragm Bolt	* 640	
3	1	Upper Flange	1000 psig 92 2000 psig 93	26	1	Spring	4078	
4	2	Nut	1000 psig * 2377 2000 psig 82B	27	2	Diaphragm Plate	89	
5	1		Spring	1527	28	1	Diaphragm	* 641
6	1	Nut	* 637	29	1	Packing Gland Assembly	* 646	
7	1	Spring Plate	1000 psig 1442SS6 2000 psig 4125	30	6	Stud 3/4-10 x 4.0	1000 psig 825 2000 psig 82A	
8	1	Screw	264	31	1	Pilot Cap	969	
9	1	Knob	635S6	32	1	Waggle Arm	1000 psig 943S6 2000 psig 944S6	
10	1	Back-up	* 148T	33	1	Pivot Bar	644	
11	1	O-Ring	* 153	34	1	Seat Assembly	* 554	
12	1	Screw	634	35	4	Screw	968	
13	1	Spacer Plate	* 90	36	1	Screw	645	
14	1	O-Ring	* 530	37	1	Case	752	
15	1	Plug	699	38	1	Screw (Rear Case Mount)	78	
16	1	Seat	* 555	39	1	Gasket	* 775	
17	1	Pilot Plug	* 563	40	1	Cover	755	
18	1	Pilot Housing	2401	41	2	Screw	966	
19	2	Gauge	7705	Item Listed Below Are Not Shown				
20	2	Screw	752A	1	Screw (Front Case Mount)		477	
21	Spacer (use to establish 1/16" at Ø)		674A	2	Screw (Pilot Mount)		967	
22	1	Lower Flange	1000 psig 1" NPT	96	2	O-Ring (Pilot Mount Seal)		569
			1/4" NPT	7129	1	Mounting Bracket	1000 psig	4428
			1" NPT	97	2000 psig	6753		
			1/4" NPT	7130	1	Nipple	648	
23	2	Diaphragm Seal Ring	673	1	Filter	YAS		
				3 PDC Pilot				YBM
				Repair Kit				RIJ

\* These parts are recommended spare parts and are stocked as repair kits.

All Pictures shown are for illustration purpose only. Actual product may vary due to product enhancement.