

DIAPHRAGM CONTROLLED HIGH PRESSURE / DIRECT ACTING MODEL DH

APPLICATION:

Used to produce a pneumatic output signal when the monitored pressure rises above the set pressure. The pneumatic source is isolated from the monitored pressure.

The control pilot may be remotely installed to operate a motor valve and function as a pressure reducing regulator.

FEATURES:

- Single Adjustment
- Filtered gas supply
- Accurate control
- Remote installation

CERTIFICATIONS:

Canadian Registration Number (CRN):
0C15143.24567890NTY

CLASSIFICATIONS:

Non-Bleed / Intermittent Vent

SUPPLY PRESSURE:

Equal to or not less than 60% of maximum upstream pressure when used to operate low pressure control valves.

20-30 psig when used to operate high pressure control valves.

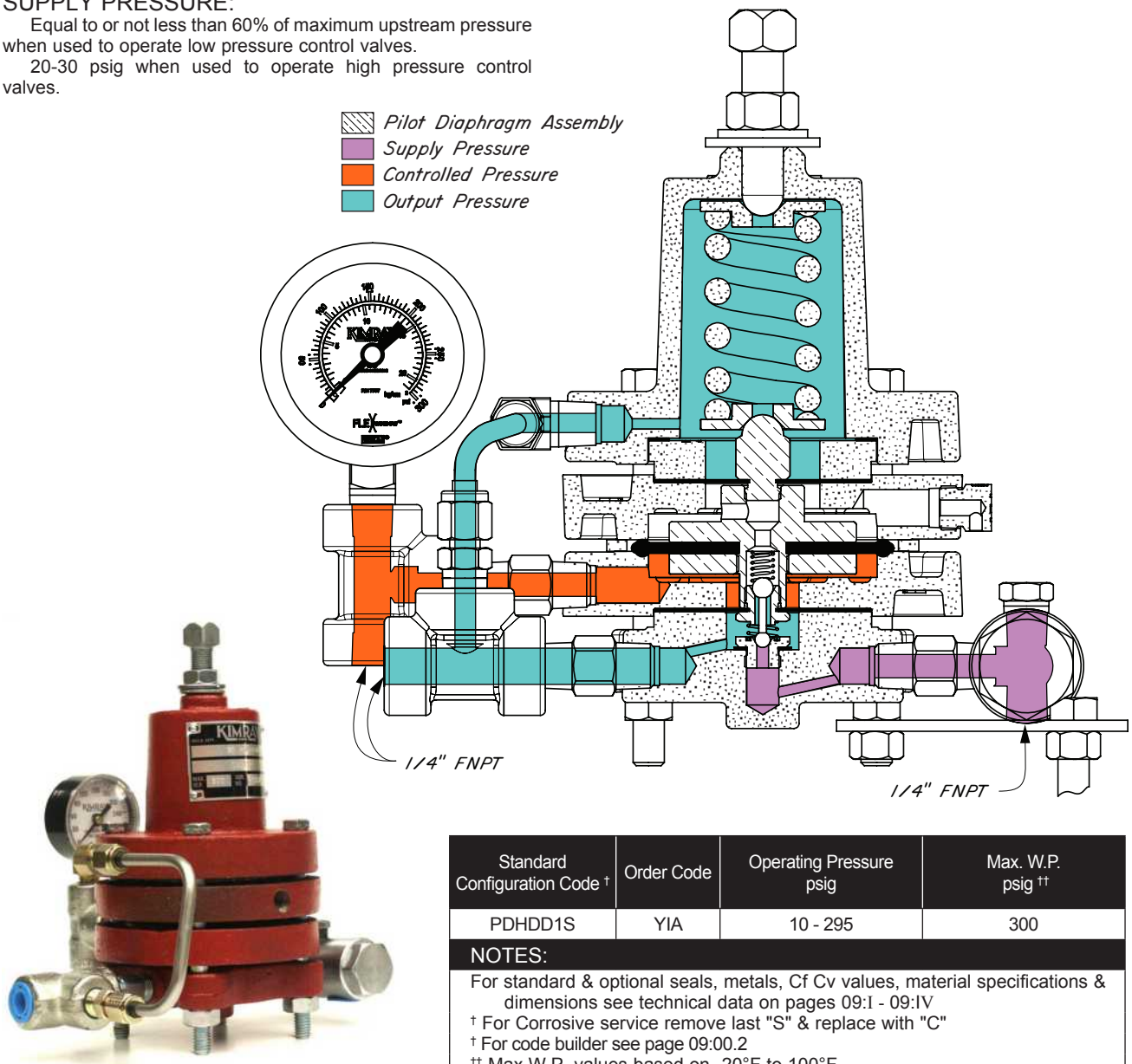

Standard Configuration Code †	Order Code	Operating Pressure psig	Max. W.P. psig ††
PDHDD1S	Y1A	10 - 295	300
NOTES:			
For standard & optional seals, metals, Cf Cv values, material specifications & dimensions see technical data on pages 09:1 - 09:1V			
† For Corrosive service remove last "S" & replace with "C"			
† For code builder see page 09:00.2			
†† Max W.P. values based on -20°F to 100°F.			

DIAPHRAGM CONTROLLED HIGH PRESSURE / DIRECT ACTING
MODEL DH DRAWING & PARTS LIST

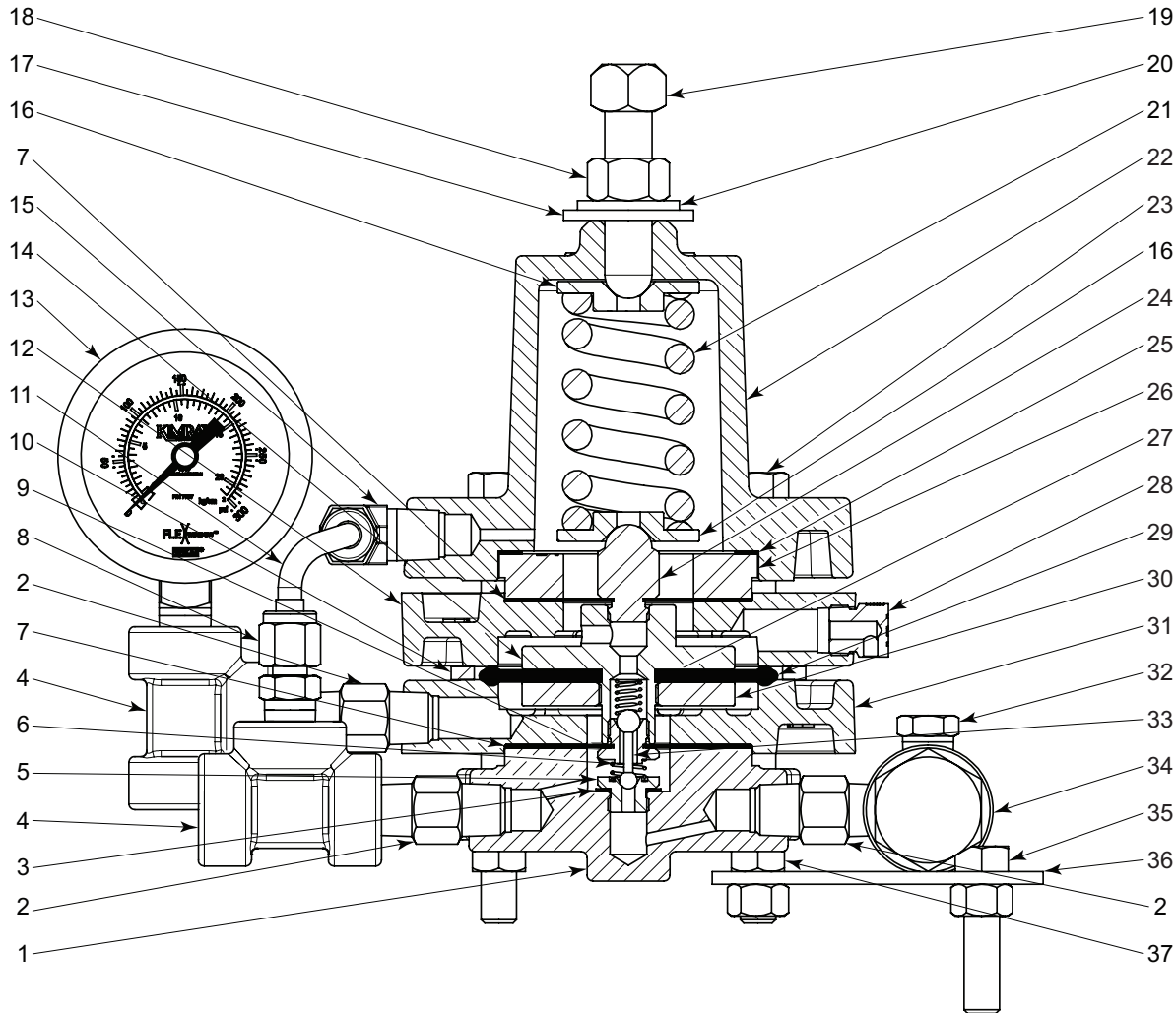

ITEM	QTY.	DESCRIPTION	PART NO		ITEM	QTY.	DESCRIPTION	PART NO	
			STANDARD	CORROSIVE				STANDARD	CORROSIVE
1	1	Base Plate	2607		20	1	Washer *	4491	
2	3	Nipple	648	648SS6	21	1	Spring	2611	
3	1	Gasket *	118		22	1	Bonnet	2610	
4	2	Tee	2000	2000SS6	23	4	Screw	4298	
5	1	Seat *	113	113SS6	24	1	Pivot Screw	2740	2740SS6
6	1	Booster Spring *	566	566HAC	25	1	Gasket *	276	
7	2	Diaphragm *	110	110V	26	1	Spacer	5097	5097SS6
8	1	Connector	874		27	1	Spring *	585	
9	1	Seat *	565	565SS6	28	1	Breather Plug	147	147SS6
10	1	Spacer Ring *	7437		29	1	Diaphragm *	5259P	
11	1	Tubing	2505SS6		30	1	Nut	107	107SS6
12	1	Housing	5098		31	1	Housing	1701	
13	1	Gauge	7707		32	1	Plug	699	699SS6
14	1	Plate	5096	5096SS6	33	1	Pilot Plug *	112	
15	1	Eil	875		34	1	Filter	YAS	YASSS6
16	2	Spring Plate	2612		35	2	Screw	430	
17	1	Packing Seal *	4488		36	1	Mounting Bracket	4428	
18	1	Nut	2377		37	8	Nut	241	
19	1	Adjusting Screw	5163						
* These parts are recommended spare parts and are stocked as repair kits.							Repair Kit	RST	RSTV

CODE BUILDER
P SERIES (PILOTS)

Series:

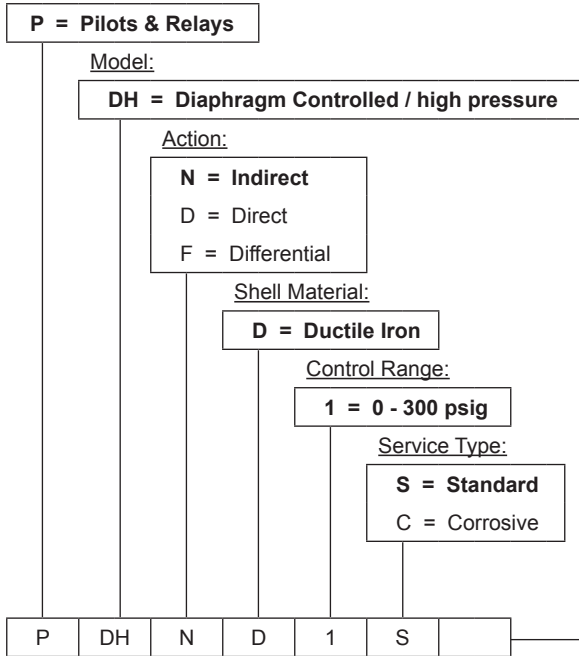

Not all selections available on all products listed.
See product pages 01:10.1 - 01:10.6 for available options

Options: Additional cost and lead times will apply
If multiple options required input in sequential order
Leave blank if no options required

- 1 = NACE Certification (Corrosive Option Only)
- 2 = Hydrostatic Test Certification
- 3 = MTR (Shell Components)
- A = AFLAS Elastomer
- H = HSN Elastomer
- V = FKM Elastomer
- X = Export (Hydrostatic test, MTR & 3.1)

Series:

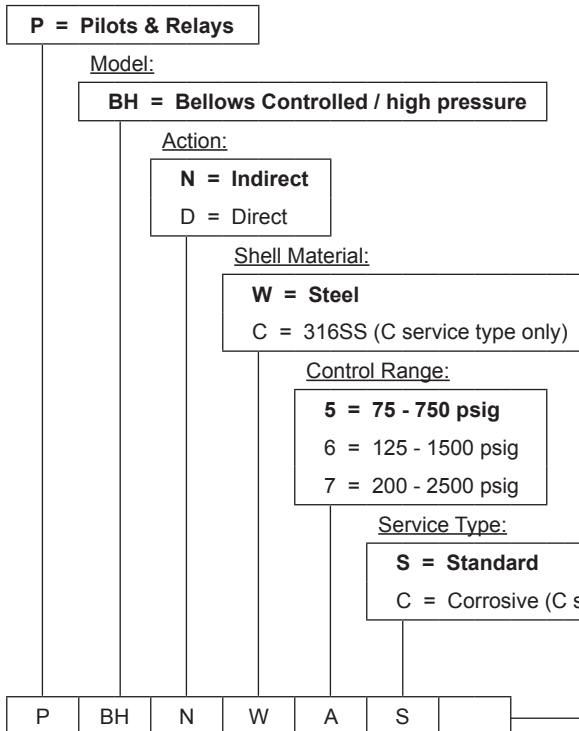

Not all selections available on all products listed.
See product pages 01:20.1 - 01:20.3 for available options

Options: Additional cost and lead times will apply
If multiple options required input in sequential order
Leave blank if no options required

- 1 = NACE Certification (Corrosive Option Only)
- 2 = Hydrostatic Test Certification
- 3 = MTR (Shell Components)
- A = AFLAS Elastomer
- H = HSN Elastomer
- V = FKM Elastomer
- X = Export (Hydrostatic test, MTR & 3.1)